

# CTP-D012-AA010

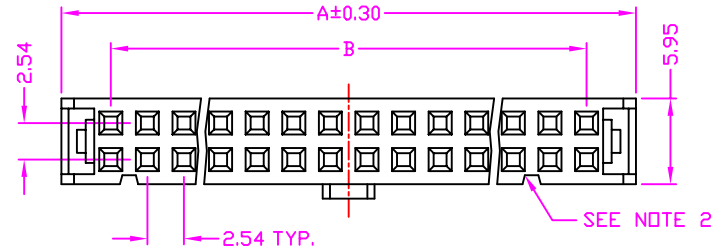

$$A = (\text{NUMBER OF POS. PER ROW} - 1) \times 2.54 + 7.10$$

$$B = (\text{NUMBER OF POS. PER ROW} - 1) \times 2.54$$

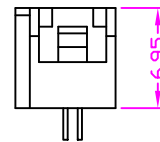
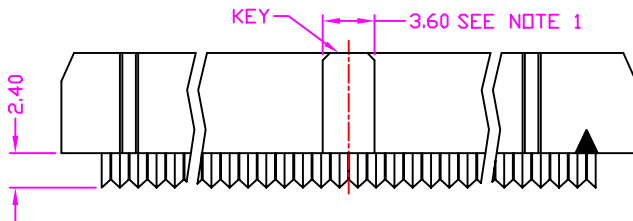

## MATERIALS

1. INSULATOR : PBT UL94V-0, BLACK
2. CONTACT : COPPER ALLOY

## OTHER INFORMATION

1. CONTACT RESISTANCE : 30m OHMS MAX.
2. DIELECTRIC WITHSTANDING VOLTAGE : 500V AC RMS FOR 1 MINUTE
3. INSULATION RESISTANCE : 5000M OHMS MIN. AT 500V DC
4. CURRENT RATING : 1 AMP. MAX.
5. OPERATING TEMPERATURE :  $-55^{\circ}\text{C} \sim +105^{\circ}\text{C}$

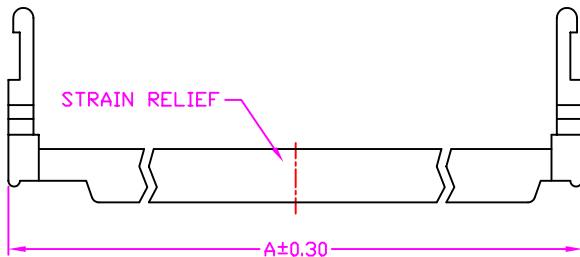
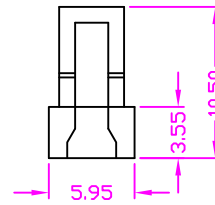
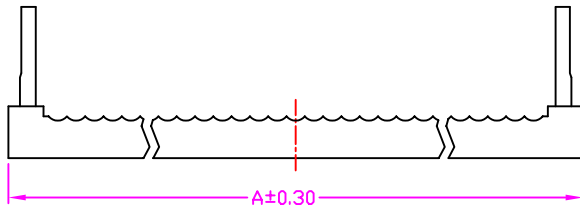

## NOTE 1:

1. WHEN 6 & 8 POSITIONS, THIS DIMENSION IS 1.85mm
2. WHEN 6 & 8 POSITIONS, WITHOUT FLUTE



Phone 1-800-809-2751

Fax 1-510-440-0579

www.connect-tech-products.com • info@connect-tech-products.com

4428 Technology Drive • Fremont, CA 94538, USA • 510-498-8815 • Fax: 510-440-0579